

GEDORE

TOOLS FOR LIFE

Retaining Ring Removal Tool Set, PSA, in a Plastic Storage Case



KL-0192-20 KA



0192-20KAe160629.docx

GEDORE Automotive GmbH

Breslauer Straße 41
78166 Donaueschingen

Postfach 1329
78154 Donaueschingen - GERMANY

Phone: +49 (0) 771 / 8 32 23-0
Fax: +49 (0) 771 / 8 32 23-90

Email: info@gedore-automotive.com
Internet: www.gedore-automotive.com

KL-0192-20 KA

Peugeot, Citroën



Scope of Delivery:



Fig. 1: Releasing the retaining ring

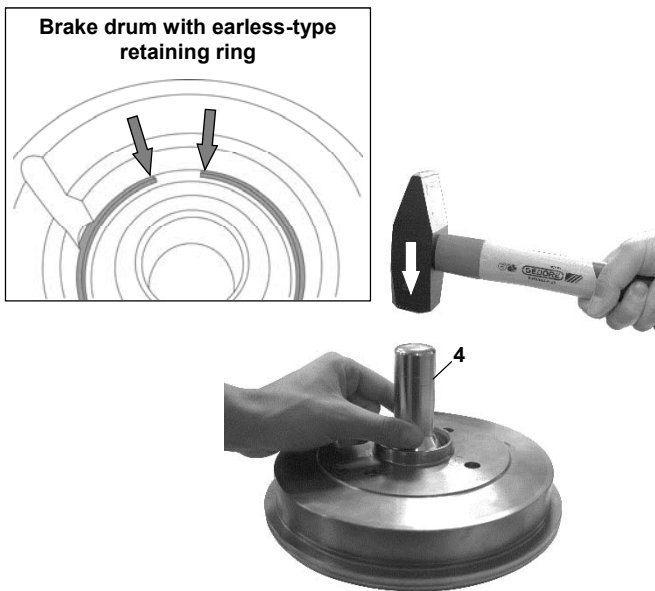

KL-0192-20 KA Retaining Ring Removal Tool Set, PSA, in a Plastic Storage Case

Suitable for use on Peugeot and Citroën vehicles equipped with drum brakes at the rear axle; such as Citroën C2 (JM), C3 I (FC), C3 Pluriel (HB), SAXO (S0, S1), XSARA (N1), XSARA Break (Estate Car) (N2), XSARA Coupé (N0); Peugeot 1007 (KM), 106 II (1), 206 Hatchback (2A/C), 206 SW (2E/K), 206+ (T3E), 208, 306 (7B, N3, N5), 306 Convertible (7D, N3, N5), 306 Hatchback (7A, 7C, N3, N5).

Field of Application

Designed for the professional separation of earless-type retaining rings from rear drum brakes with wheel bearing external Ø of 52mm. Necessary when replacing wheel bearings etc.

Scope of Delivery

Pos.	Part No.	Description	Qty
-	KL-0192-20 KA	Retaining Ring Removal Tool Set, PSA, in a Plastic Storage Case	1
<i>composed of:</i>			
-	KL-0192-20 A	Retaining Ring Removal Tool Set, PSA,	1
-	KL-2090-1103	Plastic Storage Case	1

Pos.	Part No.	Description	Qty
-	KL-0192-20 A	Retaining Ring Removal Tool Set, PSA,	1
<i>composed of:</i>			
1	KL-0192-201	Base Tool	1
2	KL-0192-202	Hook	1
3	KL-0192-203 A	Pulling Lever	1
4	KL-0192-204	Punch	1

Warnings and Notes

- Before putting the tool into operation, carry out a visual check to make sure that it is not damaged.
- Any work on vehicle axles should only be performed by qualified specialist personnel observing and complying with the directions, provisions, and safety regulations specified by the vehicle manufacturer.
- Always refer to the vehicle manufacturer's data and instructions as only these apply to all work that is carried out on the vehicle.

Example of Use:

The following instructions describe the procedure of removing an earless-type retaining ring from a rear drum brake with a wheel bearing external Ø of 52mm.

1. Release retaining ring by tapping on punch '4' with a suitable hammer. (Fig. 1)

Note: This step is necessary to separate the retaining ring from the ring groove. (Counter-pressure of wheel bearing/corrosion needs to be overcome.)

Fig. 2: Inserting the base tool and hook.

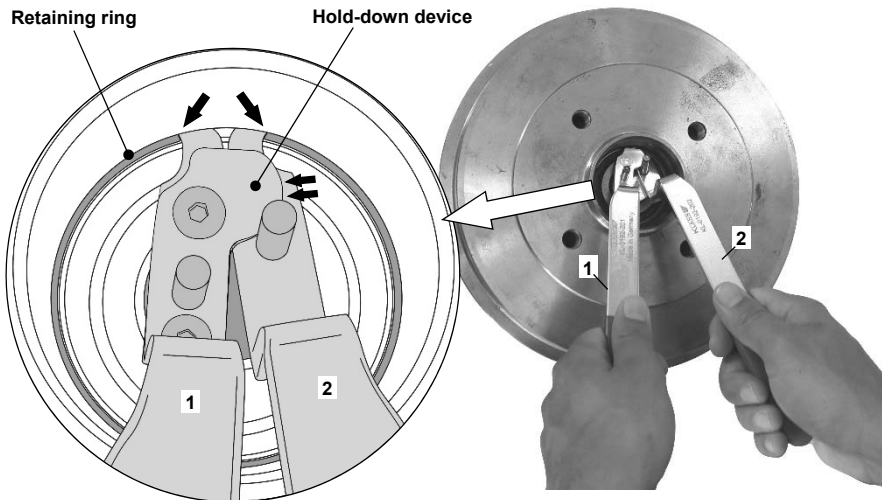

- Slide hook '2' into base tool '1' before inserting both into brake drum. Take care to ensure that hook '2' rests against the limit stop beneath the hold-down device of base tool '1'. (Fig. 3)

Insert base tool '1' along with hook '2' into brake drum as shown in Fig. 3.

Note:

Make sure that base tool '1' and hook '2' completely engage the ring groove on the retaining ring. Clean ring groove from dirt if necessary.

Fig. 3: Positioning the pulling lever/ bending the retaining ring inwards.

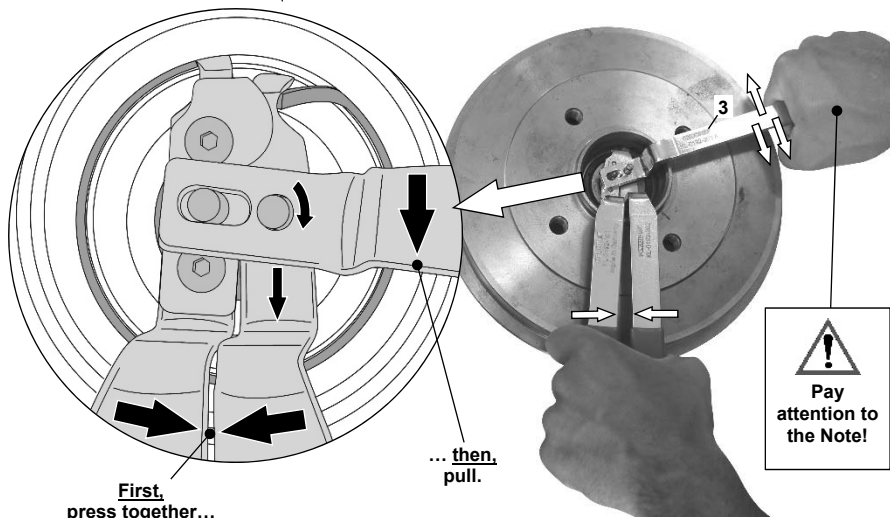

- First, press base tool '1' and hook '2' together. Next, bend earless-type retaining ring inwards by pulling with lever '3'. (Fig. 4)

! Note:

In order to prevent hook '2' from slipping out of position while bending the retaining ring inwards, observe the following instructions: Interrupt bending process 2 or 3 times and move pulling lever '3' slightly in the opposite direction of bending (to allow hook '2' to be repositioned.), continue bending process.

- Next, lever out retaining ring from ring groove using a suitable slot screwdriver or pull it out by means of a pair of needle nose pliers as appropriate. (Fig. 4)

Note:

In order to prevent the retaining ring from twisting while pulling it out, you can use base tool '1' to counter-hold.

Fig. 4: Removing the retaining ring.

Pull out bent retaining ring ...

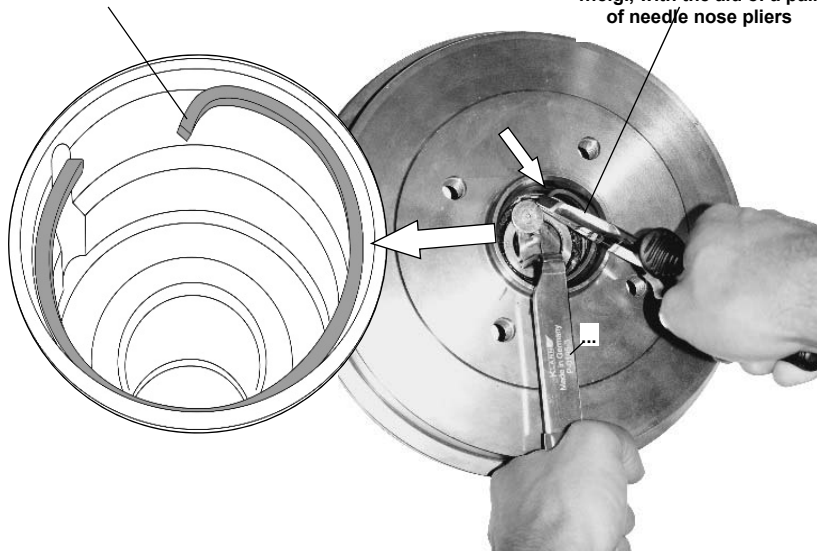

- Carry out wheel bearing replacement and reassemble vehicle in accordance with the manufacturer's instructions.

GEDORE

WERKZEUGE FÜRS LEBEN

GEDORE Automotive GmbH

Breslauer Strasse 41
78166 Donaueschingen

Postfach 1329
78154 Donaueschingen - GERMANY

Tel.: +49 (0) 771 / 8 32 23-0
Fax: +49 (0) 771 / 8 32 23-90

E-Mail: info@gedore-automotive.com
Internet: www.gedore.com

GEDORE 

formerly

KLANN 

© Copyright by **GEDORE Automotive GmbH**, Germany